

ITEM 40. WORKS ZONE – COMMONWEALTH STREET SURRY HILLS

TRIM RECORD NO: 2015/460512

RECOMMENDATION

It is recommended that the Committee endorse the reallocation of the kerb space on the western side of Commonwealth Street, Surry Hills, between the points 11.0 metres and 45.5 metres (six car spaces) south of Goulburn Street as “Works Zone 7.30am-5.30pm Mon-Fri, 7.30am-3.30pm Sat” and “4P Ticket 5.30pm-10pm Mon-Fri, 3.30pm-10pm Sat, 8am-10pm Sun and Public Holidays, subject to the following conditions:

- (A) The Applicant must comply with the Works Zone conditions as stipulated in Schedule D of this Agenda.
- (B) The Applicant is not permitted to swing or hoist goods from a Works Zone across or over any part of a public road by means of a lift, hoist or crane unless a separate approval has been obtained from the City's Building Approvals Unit under Section 68 of the Local Government Act 1993.
- (C) The Applicant must notify local residents of the Works Zone at least seven days prior to installation.
- (D) The Applicant must provide a telephone number of the Site Manager.

DECISION

BACKGROUND

SX Projects Pty Ltd has applied for a 34.5 metre long Works Zone in Commonwealth Street, Surry Hills.

The Works Zone is to facilitate construction works at 46-52 Wentworth Avenue for a period of approximately 52 weeks.

COMMENTS

The kerb space on the western side of Commonwealth Street, Surry Hills between Goulburn Street and Hunt Street, where the Works Zone is proposed, is currently signposted as ‘2P Ticket 8am-6pm Mon-Fri, 4P Ticket 6pm-10pm Mon-Fri, 8am-10pm Sat, Sun and Public Holidays and “No Parking” across site driveway.

The Works Zone is intended to operate from 7.30am to 5.30pm, Mondays to Fridays and from 7.30am to 3.30pm on Saturdays in accordance with the Development Consent Conditions.

The development site has no provision for off-street parking for large trucks and as the approved development takes up the entire site, the Developer is unable to carry out construction unless a Works Zone is provided directly in front of the site. The street is wide enough to allow the Works Zone to be installed without affecting traffic flow or property access.

CONSULTATION

The Applicant must notify adjacent properties at least seven days prior to the implementation of the Works Zone.

FINANCIAL



All costs associated with the Works Zone will be borne by the Applicant.

ATTACHMENTS

Works Zone – Commonwealth Street Surry Hills

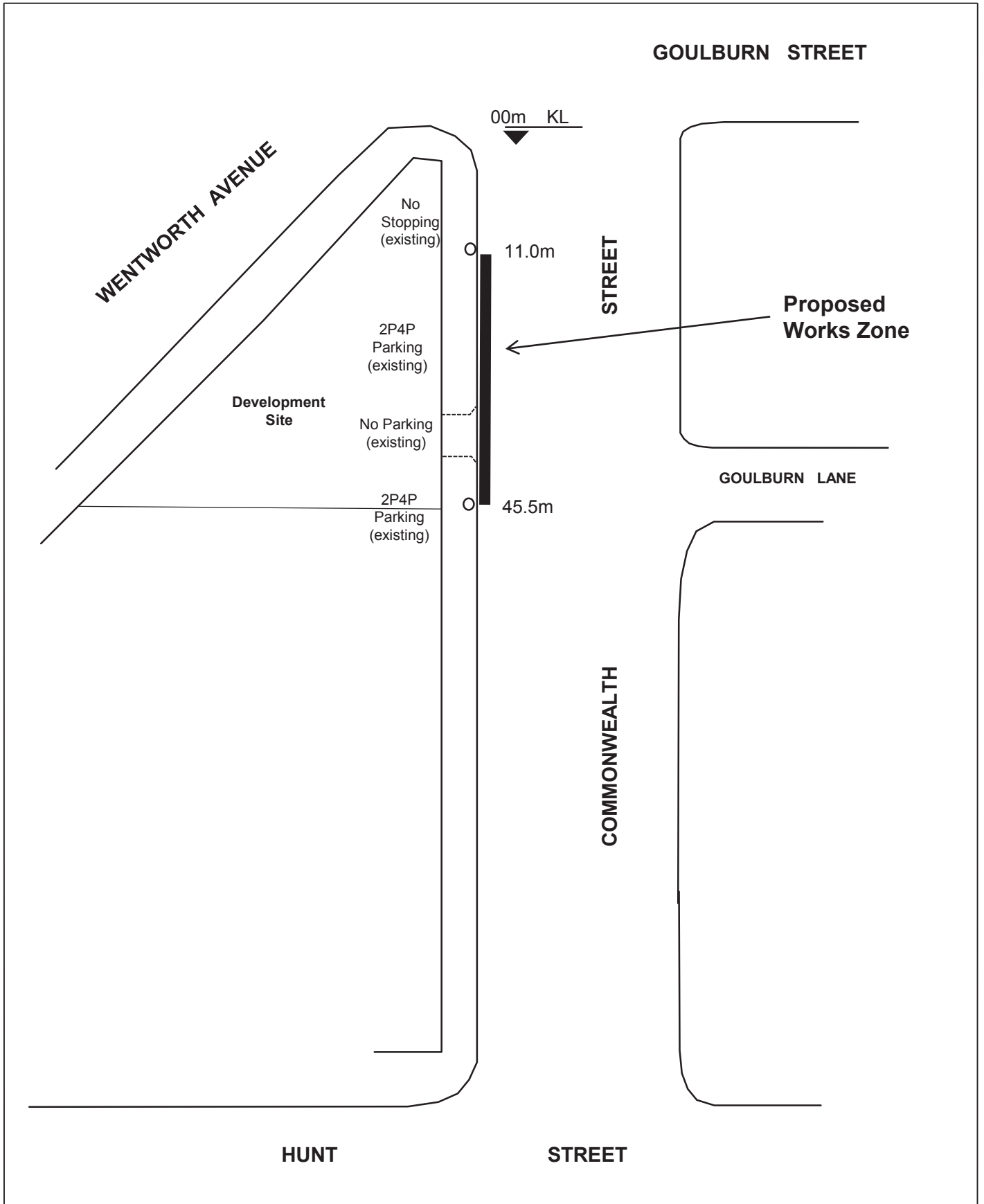
Ajay Nayyar, Traffic Works Coordinator



	PROPOSAL	
	COMMONWEALTH STREET, SURRY HILLS REQUEST FOR WORKS ZONE	

